

Step One

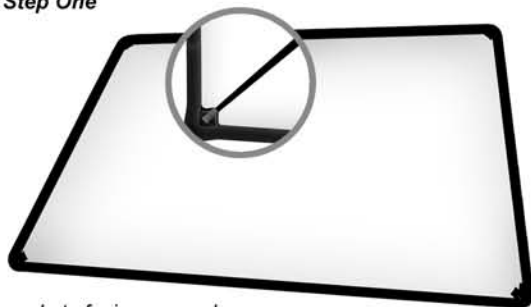

pockets facing upwards

Step Two

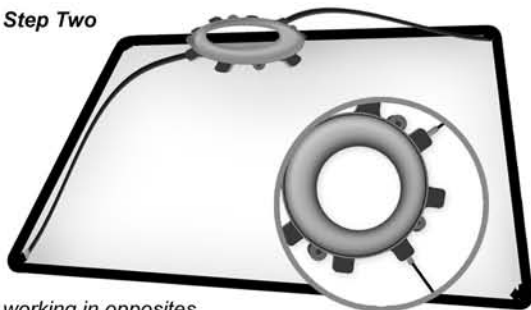

working in opposites

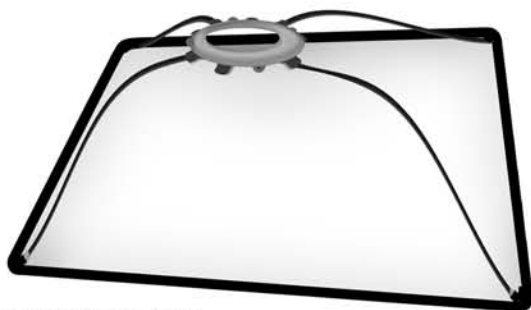

completing the frame

Step Three



attaching the outside cover

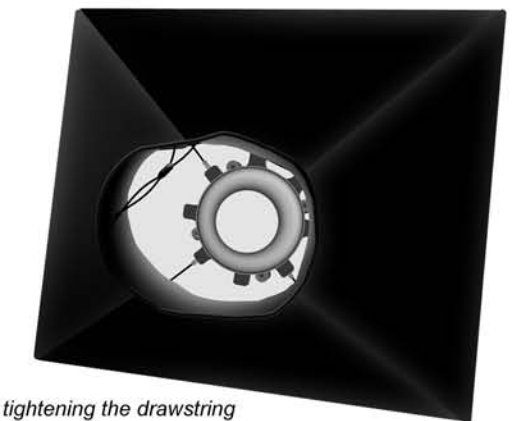

tightening the drawstring

How To Assemble Your Paul C. Buff Softbox

Materials Needed (these items are included with your softbox):

1 LGSR Rotating Speedring

the rotating speedring fits on the faceplate of your White Lightning and / or AlienBees flash unit, in place of the standard reflector

4 Flexible Metal Poles

the poles create the frame of the softbox

1 Translucent White Front Diffusion Panel

the front panel has a black velcro trim with pockets on the inside corners for the metal poles to fit in

1 Opaque Black Outside Cover

the outside cover has a black exterior with a silver-lined interior

1 Translucent White Internal Diffusion Panel

this optional second diffusion panel is attached to the inside walls of the black cover with velcro tabs

Step One:

Take the **Translucent White Front Diffusion Panel** and spread it out flat on the floor, with the velcro trim facing upwards. The pockets in each of the four corners will be facing upwards (these pockets are for the metal poles).

Step Two:

You will construct the frame of the softbox using the **Flexible Metal Poles**. Take the **Rotating Speedring** (with the smaller side facing up) and bow the poles from opposing corners towards the holes in the speedring. The poles will fit snugly into the holes of the speedring and into the pockets in each of the four corners of the inside front panel, running along the inner seams. The bowed poles and speedring center make the frame for the softbox. It is easiest to begin in one corner, then move to the opposite side to place your next pole. Once all four poles have been arranged, fitting in the pockets of the front panel and the holes in the speedring, the frame is complete.

Step Three:

Take the **Opaque Black Outside Cover** and slide it over the frame, lining up the corners. The velcro trim of the outside cover will attach to the velcro trim of the front panel. With the cover in place, fasten the velcro trim around the edges. (Leave one side open so that you can slide your hand in for step four).

Step Four (Optional):

For double diffusion, you can attach the second **Translucent White Internal Diffusion Panel** to the inside of the softbox. The internal panel is attached by affixing the small velcro tabs on its edges to the corresponding velcro tabs on the inside silver lined walls of the outside cover.

Step Five:

Secure the velcro trim around the entire face of the softbox, and tighten the drawstring around the speedring. This drawstring gathers the opaque black material to fit snugly around the speedring and prevent light spill. Once all of the velcro is secured and the string is tightened, your softbox is ready to be mounted to your flash unit. The speedring fits on the front faceplate of your flash unit, around the flashtube and modeling lamp, in place of the Standard 7-inch Reflector. The speedring is held in place with the four holding fingers. Please ensure that **all four** fingers are inside, gripping the speedring to hold it securely in place.

Paul C. Buff

The Paul C. Buff Softbox is designed for use with Paul C. Buff, Inc. flash units (including the White Lightning Ultra, UltraZAP, X-Series and AlienBees models)

Paul C. Buff, Inc. • 2725 Bransford Avenue Nashville, Tennessee 37204
Toll Free 1-800-443-5542 • Local (615) 383-3982 • Fax (615) 383-0676